

A One Piece Mounting System

10° & 15° fixed tilt available

Call Us Today And Compare
+1 877 847 8919

The Renusol CS60 is a one piece PV mounting system for flat roof applications available in 10° and 15° tilts. The product is made from a 100% recycled high molecular weight polyethylene (HMWPE). This durable system transports easily and sets up quickly. Most projects require minimal ballast and no roof penetration. One PV module mounts directly to one Renusol CS60; no complex project design or complicated assembly required. The universal design accommodates all common PV modules. The mounting system requires no grounding since it is made of non-conductive material. Project design can be customized to meet a needed roof pressure. The simplicity of the Renusol CS60 saves installation time and reduces overall project costs.

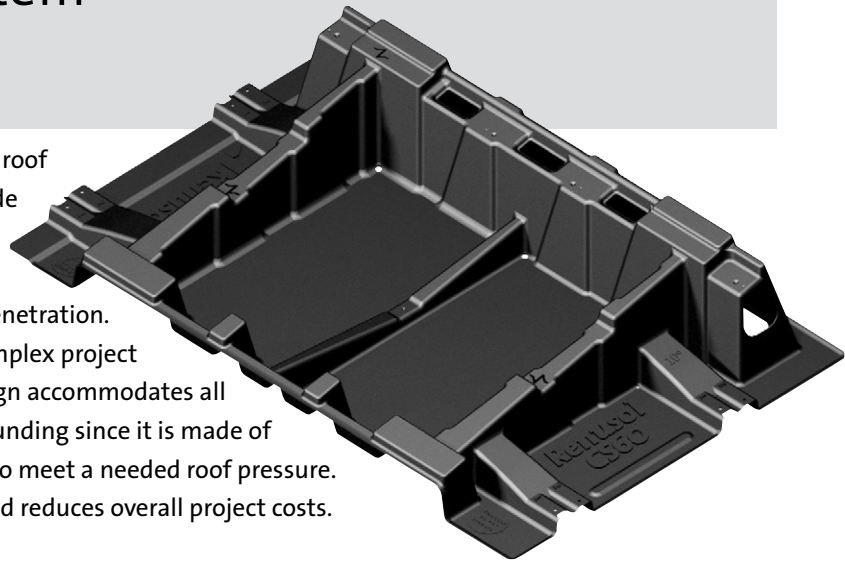

The Renusol CS60 Benefits

Quick, Easy and Cost-Efficient Install

- Complete kit in 1 box
- Installs quickly with minimal parts
- 1 Renusol CS60 = 1PV Module
- PV panel mounts directly to Renusol CS60
- Durable, non-conductive material

Safety and Security

- Wire management channels
- No trip hazards between rows
- Enclosed ballast tray
- Evenly distributes weight across roof surface

Flexible

- Simple to design projects
- Fits common aluminum framed PV modules
- Stackable, easy to move and ship
- Design customizable to meet roof pressure limitations

Product and Project Support

- Project specific engineering documents
- Expert technical support



Reliable and Environmentally Sound

- 100% recycled and recyclable
- Impact and UV resistant
- Most comprehensive wind tunnel testing to date (up to 150 mph)
- Integrated air foil minimizes ballast

Additional Features 10° Tilt Product

- Built-in wire management channels with "Z" notch for easy fastening
- Adjustable East/West connection to accommodate either high density installation or larger module needs

Installation Steps

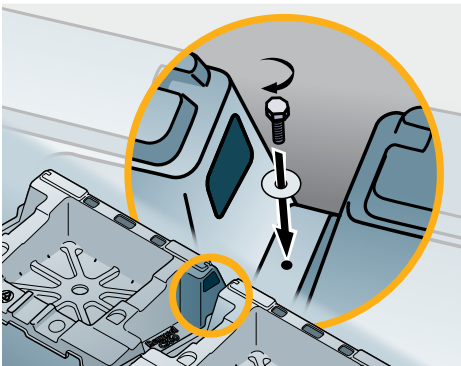

Fasten East-West, add ballast if needed

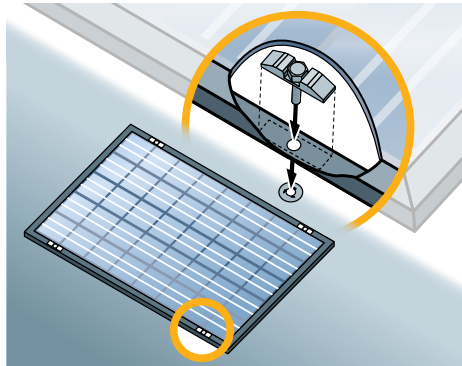

Install T-Washer on module frame

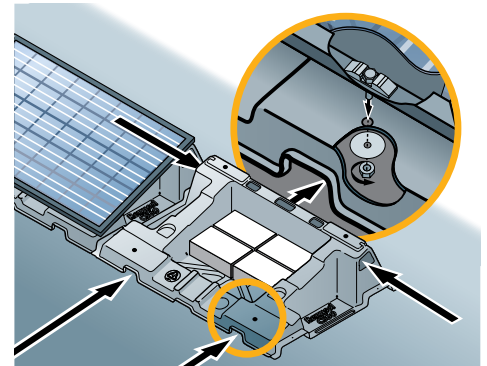

Fasten panel to Renusol CS60

TECHNICAL SPECIFICATIONS

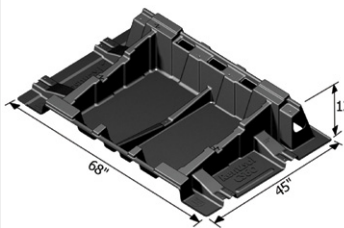
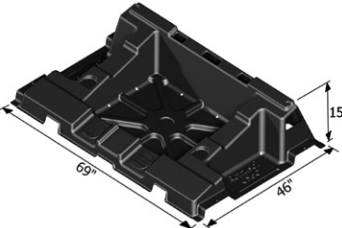
Product Name	Renusol CS60 10° Tilt Angle	Renusol CS60 15° Tilt Angle
Image & Dimensions		
System	Ballasted flat roof system compatible with optional roof anchoring	
Materials	100% Recycled HMWPE (High Molecular Weight Polyethylene)	
Roof pitch range	0° to 5°	
Product Weight	19 lbs	
Ballast Size	Optimized for 4" x 8" x 16" block but gravel, bricks or pavers can be used	
Ventilation	Slots on top, bottom and sides	
Module Type	For PV modules with aluminum frames	
Size Range	Up to 1020mm wide and up to 1685mm long	
Orientation	Landscape	
Wind testing	Wind tunnel tested in accordance with ASCE 7-05 & 7-10	
Warranty	25 years	
Training	On-site upon request	
Support	Telephone, email and on-site. Engineering provided.	

About Renusol

Renusol America is a leading innovator in flat-roof and pitch-roofed mounting systems for Solar PV modules in the US solar industry. Renusol America provides sales, service, and customer support from its headquarters in Atlanta, Georgia and operates full-scale ware-house and distribution facilities across the country. In 2011 Renusol America introduced the groundbreaking, American-made Renusol CS60 – the first one piece mounting system for PV panels - combining a heritage of German engineering with American innovation and production. The company is part of the CentroSolar Group, a publicly traded company on the German stock exchange, and is a wholly owned subsidiary of Renusol GmbH, a market leader in Europe with more than 600MW of solar power mounted on Renusol systems.

FAQs

Are roof protection mats required?

The Renusol CS60 has no sharp edges that contact the roof. Slip sheets may be required if it is needed to increase the friction coefficient.

Is grounding required?

The Renusol CS60 base is made of non-conductive material and requires no grounding.

Is anchoring required?

Projects in seismic areas or modules mounted in high wind zones may require roof anchoring. The Renusol CS60 is designed to easily attach to these anchors.

What material can be used as ballast?

It is recommended to use solid concrete block commonly found at local building supply companies.

Was wind analysis done by computer simulation or physical testing?

Physical testing in a wind tunnel was performed in accordance with ASCE to ensure the Renusol CS60 performs well in the field.

Is the material UV resistant?

The Renusol CS60 base is made of recycled HMWPE (High Molecular Weight Polyethylene) with UV stabilizing agents that give it excellent UV resistant characteristics.

How long is the warranty?

The warranty period is 25 years. See "Renusol America 25-year Limited Product Warranty" for full details.

How many have been installed to date?

Over 1,000,000 modules have been installed with this type of product through our parent company in Europe. The first large scale installations began in 1996.